

REVISION SCHEDULE		
REV	DATE	DESCRIPTION

1	29.09.20	External Dimensions added
---	----------	---------------------------

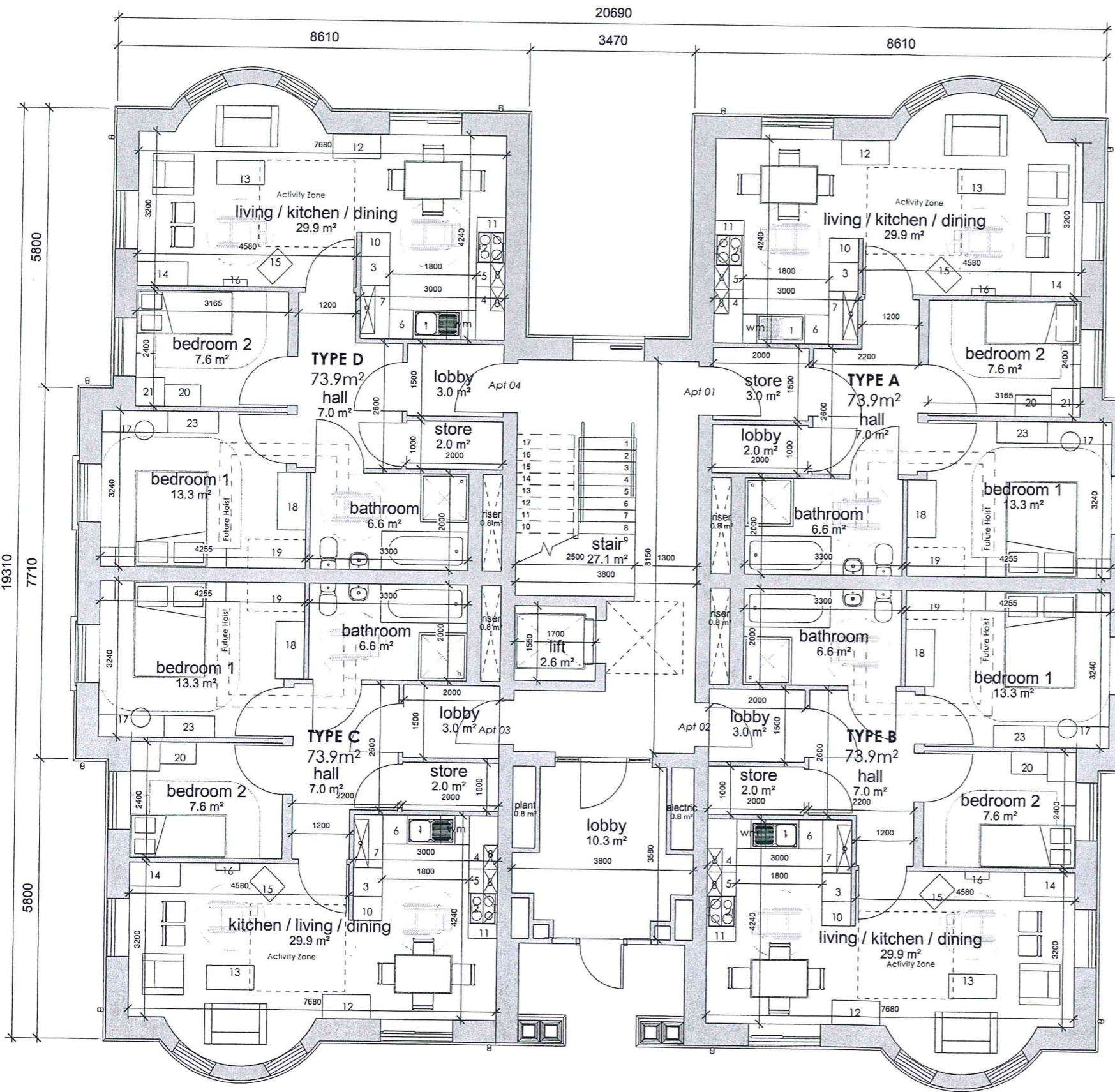

LA10/20/0950

Fermanagh and Omagh District Council
Drawing Number 01

Apartment Type Schedule

Type A:	1, 5, 9
Type B:	2, 6, 10
Type C:	3, 7, 11
Type D:	4, 8, 12

Furniture Schedule

1.	Sink Unit
2.	Cooker
3.	Fridge/Freezer
4.	Future Appliance Unit
5.	(500) Drawer Set
6.	(500) Base Unit
7.	(1000) Base Unit
8.	(500) Wall Unit
9.	(1000) Wall Unit
10.	Tall Unit
11.	30 Litre Recycling Unit
22.	Washing Machine
12.	Storage Unit
13.	Coffee Table
14.	PC Desk
15.	TV
16.	Focal Point
17.	Dressing Table & Stool
18.	Double Wardrobe
19.	Future Cot Space
20.	Chest of Drawers (450x750mm)
21.	Single Wardrobe
23.	Chest of Drawers (450 x 1050mm)

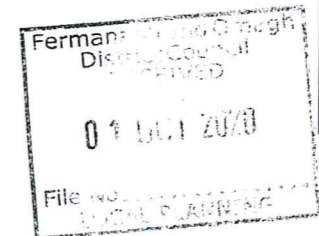

Revision	Date	Drawn By
P2	27/08/2020	RG
SEE REVISIONS ABOVE		
Revision	Date	Drawn By
P1	27/08/2020	RG
SEE REVISIONS ABOVE		
Revision	Date	Drawn By
01	12/08/2020	LM
First Issue		

The use of this data by the recipient acts as an agreement of the following statements. Do not use this data if you do not agree with any of the following statements:- All drawings are based upon site information supplied by third parties and as such their accuracy cannot be guaranteed. All features are approximate and subject to clarification by a detailed topographical survey, statutory service enquiries and confirmation of the legal boundaries. Do not scale the drawing, use figured dimensions in all cases, check all dimensions on site. Report discrepancies in writing to Gravity Architects before proceeding.

Status	
Planning Drawings	
Project	
NI356 Woodbrook Hall Apartments, Omagh	
Drawn	
Ground Floor Plan	
Project	Drawn
NI356	NI356-GA-00-01-DR-A-100-P2
Scale: at	Drawn
1 : 100	LM

00 GROUND FLOOR
1 : 100